

DORCAS

PROFAST

—
Electromagnetic lock
for door profile

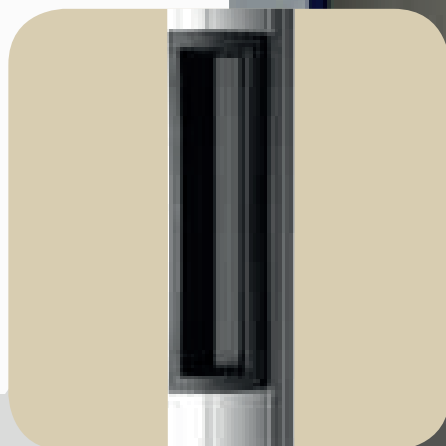

10 MINUTS

H.R.V.
HIGH RESISTANCE
TO VANDALISM

Technical features

- NFS 61-937.
- Pre-ensambled.
- Quick installation.
- Aesthetic installation. It covers previous installations holes.
- Pre-drilled profile adjustment.
- Ergonomic design.
- Anodized aluminium finish.
- Recommended for metal, wood and glass installations.
- Wires hidden.

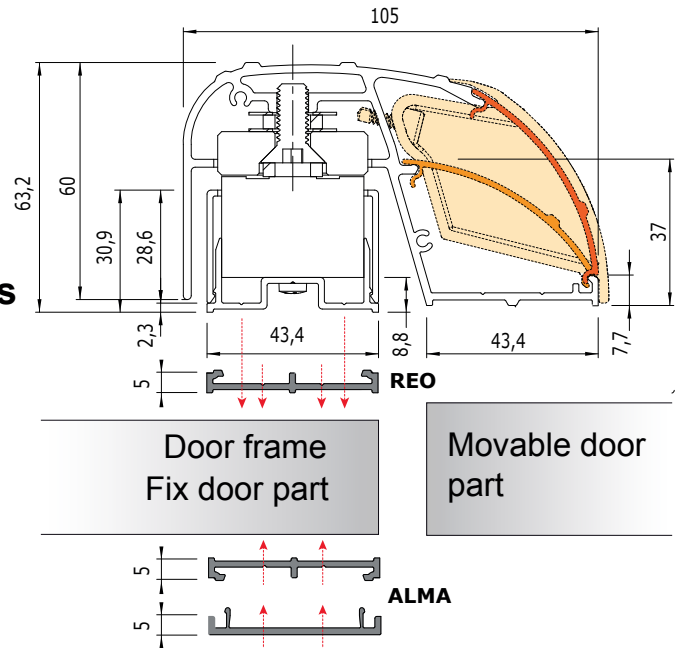

Information and recommendations:

The system is designed to allow two electromagnetic locks with a 300 Kg each. They can work together and work with a power supply of 12 or 24 VDC (48 VDC personalized). Power consumption depends on the number of electromagnetic locks installed and the working power supply (V).

Both parts of the installation must be installed on the door and door frame surface, remaining parallel when the door was closed. Before wiring, watch the diagram. We recommend a maximum wire distance of 10 meters between installation and electromagnetic locks in order





to avoid a voltage drop. If distance is over, you should increase the wire section.

Please ensure the handle with the two screws inside it's place.

TECHNICAL FEATURES	
Long	2190 / 2500 mm
Width	105 mm
Depth	63 mm
	12 / 24 / 48 Vdc
Holding strength (Kg)	2 x 300 Kg
DC current consumption (mA)	550 (by close) 275 (by close) 190 (two closes)

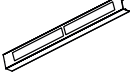

Components:

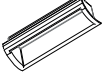
						
	Handle profile	Handle profile cover	Back container box	Container box covers	End covers	Handle
PROFAST	1	1	1	1	2	1

Installation:

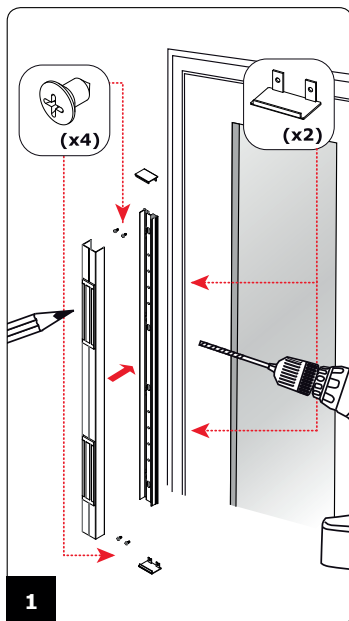

Fix the back container box with the electromagnetic locks pre-assembled on the door frame or in the fixed door part if it's double door.

Make sure the position allows the handle to close securely. Once the position is right, mark the vertical and horizontal holes and drill. Please insert the wires through their respective holes.

Fix the piece and wire the electromagnetic locks.

Fix the cover with screws provided, tighten and fix the cap and side trims.

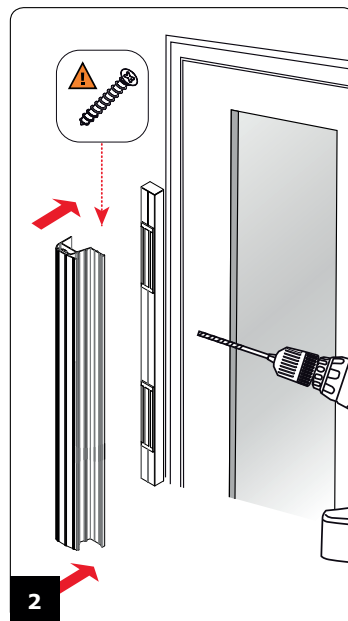

With the door closer, fix the profile on the sheet edge of the movable door, ensuring the handle covers the box.

Mark the horizontal and vertical holes, drill and fix the handle temporarily with space around the box.

Ensure the alignment of electromagnetic locks with the container box, adjust if it's necessary and when it was correctly, fix the handle with their fixations.

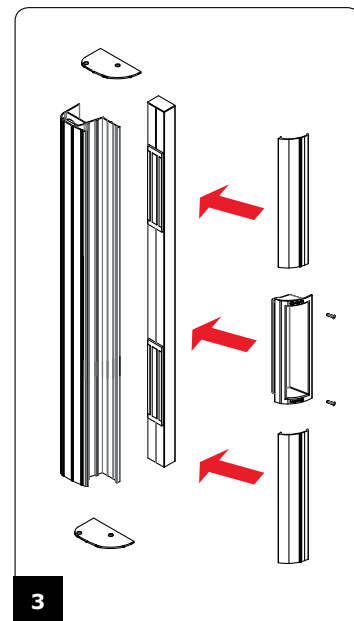

Cut the upper cover in two parts. Ensure each dimensions before cutting. Think on 215mm plastic handle.

Ensure the handle in the best position for the users, then cut covers finally.

Fix trims. Insert plastic handle with two screws.

Wiring:

Example 1: With exit button

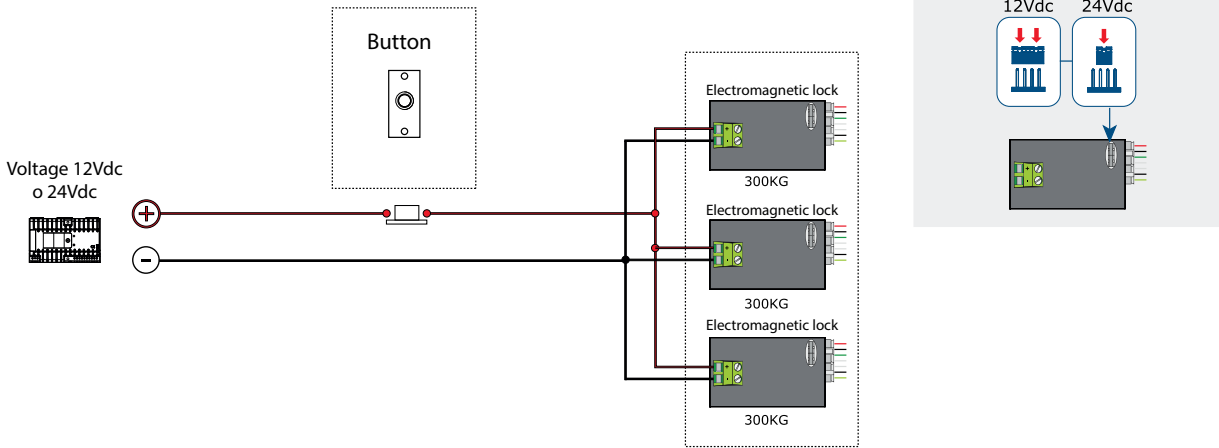

Example 2 With exit button and access control

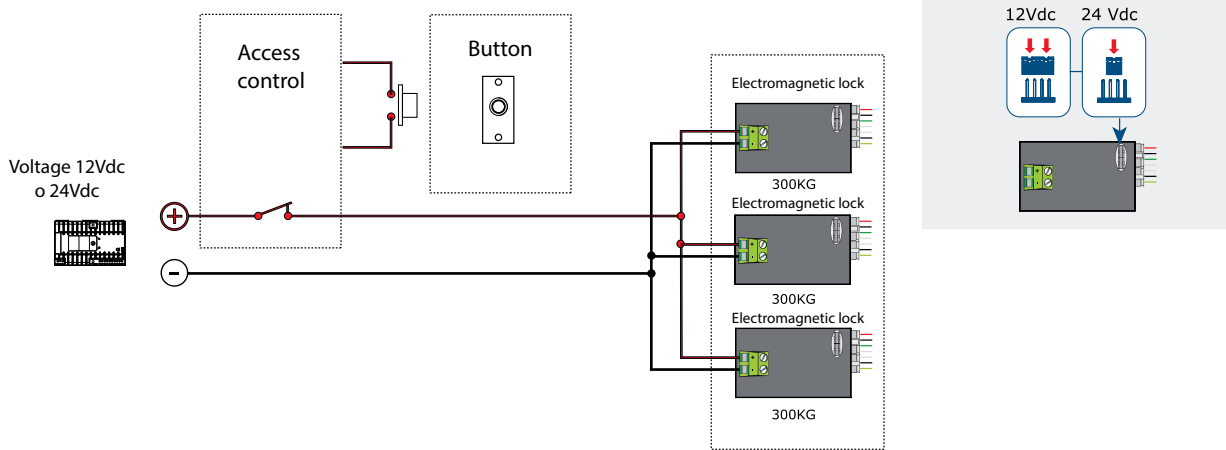



DORCAS

Montajes electrónicos DORCAS S.L.
C/ José Serrano, 6
46392 Siete Aguas | Valencia | España

Tel. 96 234 10 00 | Fax. 96 234 01 62
Tel. export: +34 96 234 18 03
Fax. export: +34 96 234 18 06

www.dorcas.com